



V001

# boardprep

5 Circuit Road Westmead 3608 | Tel: 031 700 3187  
Fax: 031 700 3781 | www.boardprep.co.za

## DOUBLE WINE RACK

### ASSEMBLY INSTRUCTIONS

#### TOOLS REQUIRED:

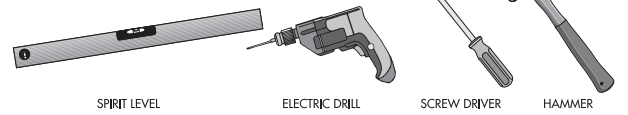

#### FITTINGS REQUIRED:

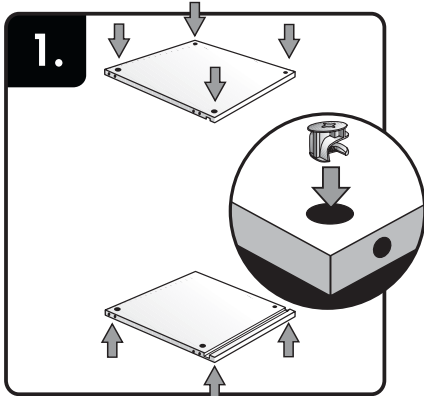
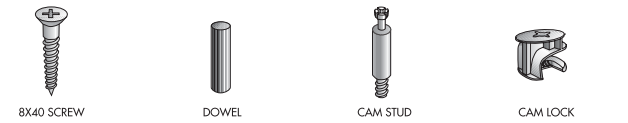

1. Place cam locks in pre drilled holes, in top and bottom panel with grooves facing inward.

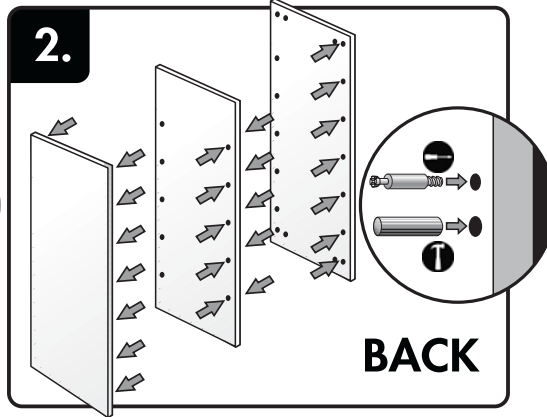

2. Screw studs and press dowels into pre-drilled holes in side panels and both sides of centre divide.

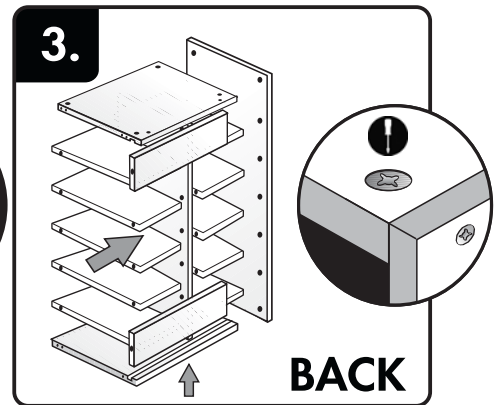

3. Join side panel and support rails then fasten cam locks.

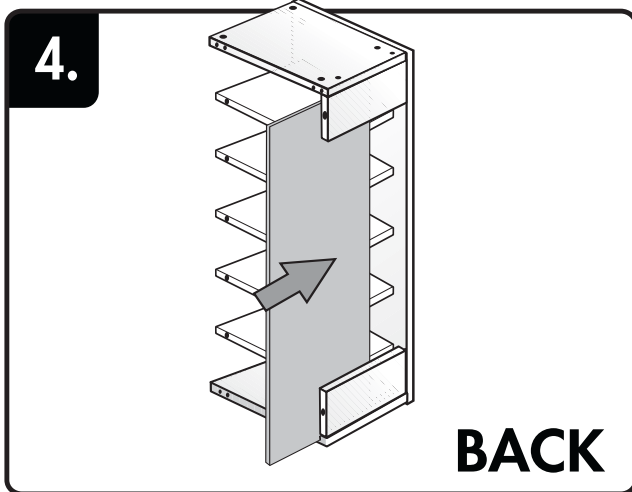

4. Insert back panel into groove in top and side panels.

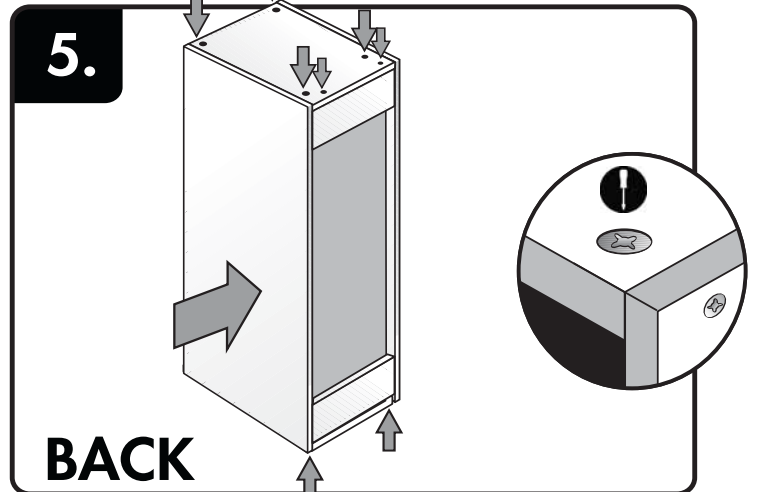

5. Join second side and fasten cam locks into position. Screw back rails into position.

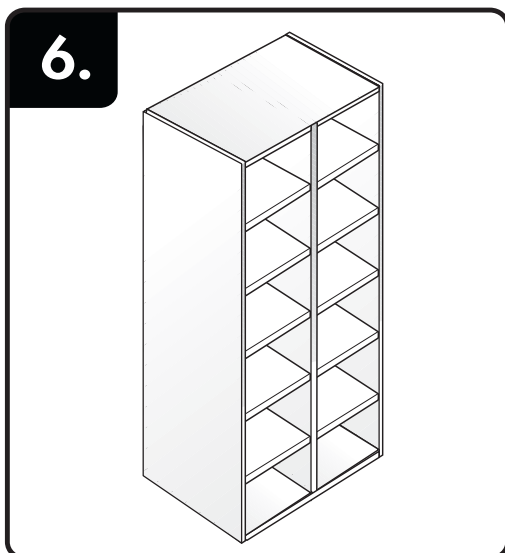

6. Unit is complete.

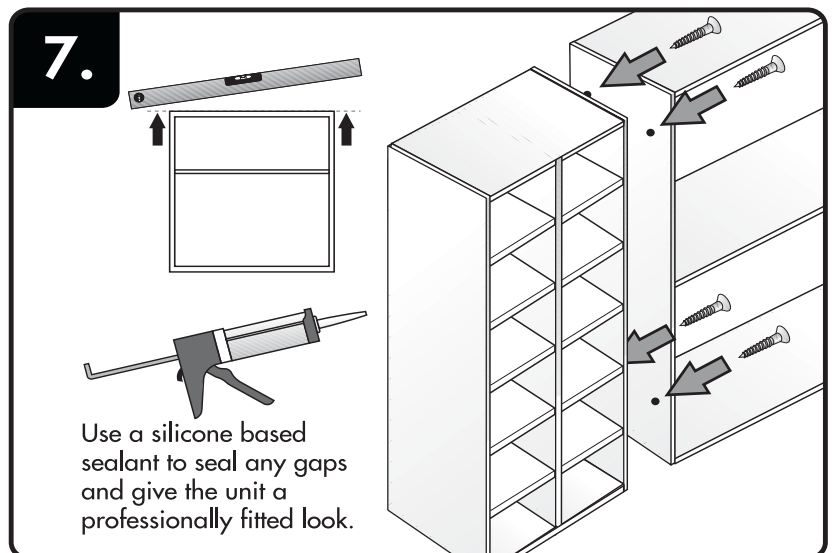

7. Use a silicone based sealant to seal any gaps and give the unit a professionally fitted look. Place the cupboard in its final position and screw the unit into position from the adjacent unit, so that they attach flush to each other. Always use a spirit level to ensure unit is level when fixing it to the adjacent unit.